

# tray wrapper instruction manual

## TW45 & TWS45 MODELS

This manual is produced by Mantle Packaging Machinery Ltd for the benefit of machine users and should be carefully studied prior to installation or operation of the machine, and then kept safely for the training purposes of future operators. Although every effort is made to ensure that the information in this manual is accurate, due to continuing improvement and development, some of the content may differ in some way from the machine that you have. On receipt the machine should be thoroughly inspected and any damage should be notified to the carrier and Mantle Packaging Machinery Ltd immediately.

### DESCRIPTION & SPECIFICATION

The machine is robustly constructed from the finest materials available and each unit is guaranteed for 12 months against faulty workmanship. Following years of experience in Food Packaging Machinery, this machine has been manufactured to meet the need for a simple yet workmanlike machine.

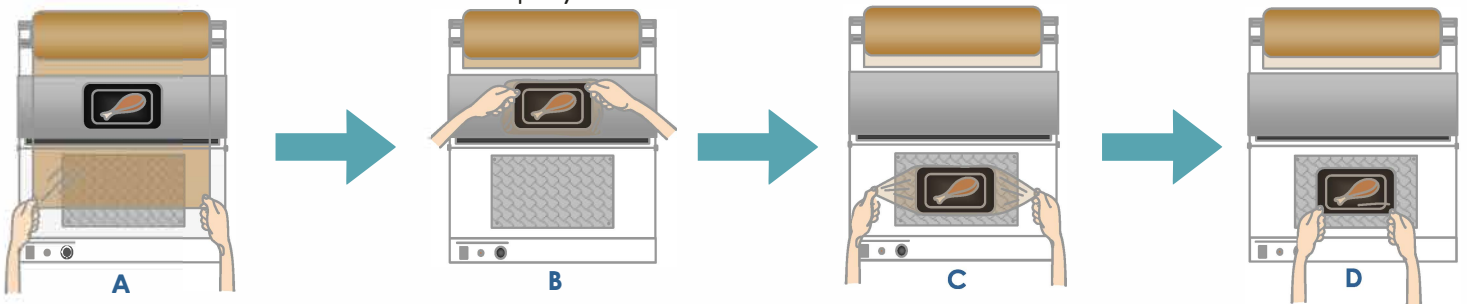

### INSTRUCTIONS FOR USE

1. Unpack the Tray Wrapper and place it on a flat surface within 2 metres of an electrical supply.
2. Place a roll of stretch film on the twin rollers at the rear of the machine with the film edge unwinding from the bottom of the roll.
3. Lift the hinged stainless bridge and pass the film under the bridge.
4. Secure the brake screw, (M6 x 20mm) provided in the spare parts packet, into the threaded bush at the rear of the machine. The brake screw, when tightened, prevents the free running of the film when in use. **Please Note** - Do not over tighten the screw, as this will prevent the rollers from turning.
5. Plug the Tray Overwrapper into a 13amp electrical supply and switch on (Amber Switch). Set the Hot Plate temperature dial to 3 and allow approximately 10 minutes to reach the set temperature.
6. Place the pack to be wrapped on the stainless bridge, pull the film forward with both hands and take it over the top of the pack allowing approximately 25mm to be tucked under the rear of the pack. (Fig A & B).
7. Holding the film and the pack together, lift and bring forward, at the same time cut the film on the hot wire at the rear of the pack. Quickly lower the pack on to the Hot Plate to create the first seal. (Fig C).
8. Stretch the excess side film and tuck underneath the pack. Return to the Hot Plate to complete the seal. (Fig D).

**ELECTRICAL SUPPLY:-** 220/240 Vac; Single Phase; 3 Amps  
**DIMENSIONS:-** 660 x 510mm  
**MANUFACTURER:-** Mantle Packaging Machinery Ltd



### \*\*PLEASE SEE THE REVERSE OF THIS MANUAL FOR REPLACEMENT PARTS DIAGRAM\*\*

#### DIRECTIVE 2002/96/EC ON WASTE ELECTRICAL AND ELECTRONIC EQUIPMENT (WEEE)

The WEEE Directive aims to reduce the quantity of waste from electrical and electronic equipment and increase its reuse, recovery and recycling. Mantle Packaging machines are marked with the "cross out wheeled bin symbol" to ensure they are dealt with separately from general waste. When the machine has reached the end of its use, please arrange to have it returned to Mantle Packaging Machinery Ltd and we will ensure that it is either recycled correctly or disposed of safely. We will record details of all returned and recycled machines. **WEEE Reg No: WEE/DA2698TX**

### WE ARE PROUD MEMBERS OF



Units 1 & 2 The Sidings,  
Whalley, Lancashire, BB7 9SE  
Tel: 01254 824992

Email: [orders@mantlepackaging.co.uk](mailto:orders@mantlepackaging.co.uk)  
Website: [www.mantlepackaging.co.uk](http://www.mantlepackaging.co.uk)

# tray wrapper range parts diagram

## TW45 & TWS45 HOT WIRE MODELS

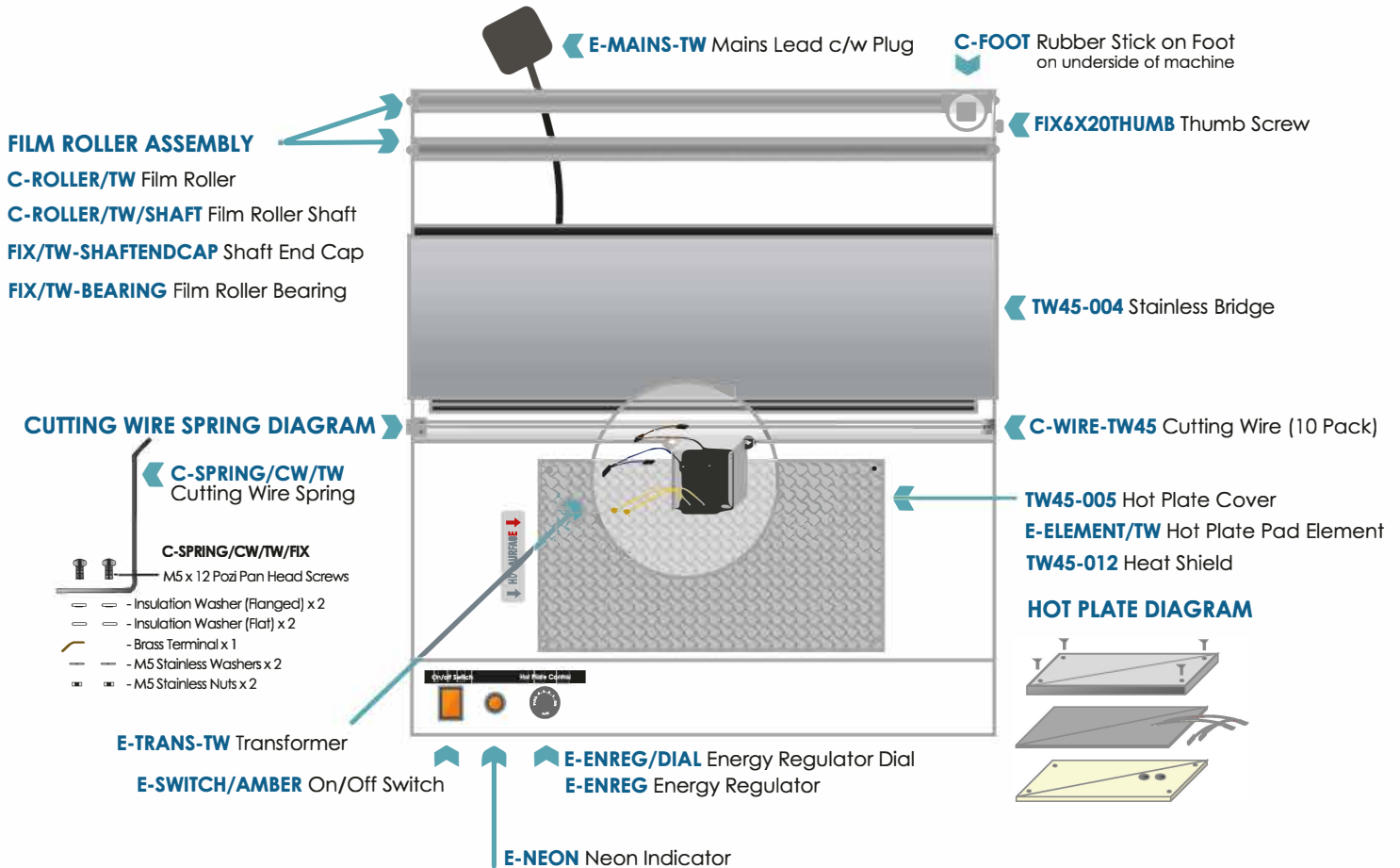

**\*\*IMPORTANT PLEASE NOTE\*\***

Only resistance wire should be used to replace the cutting wire, using any other kind of wire will invalidate the warranty of your machine and may damage electrical components.

**ELECTRICAL SUPPLY:-**

220/240 Vac: Single Phase: 3 Amps

**DIMENSIONS:-**

660mm x 510mm

**MANUFACTURER:-**

Mantle Packaging Machinery Ltd



**WE ARE PROUD MEMBERS OF**



Units 1 & 2 The Sidings,  
Whalley, Lancashire, BB7 9SE

Tel: 01254 824992

Email: [orders@mantlepackaging.co.uk](mailto:orders@mantlepackaging.co.uk)

Website: [www.mantlepackaging.co.uk](http://www.mantlepackaging.co.uk)